

# The Key Room

FINE FOOD~EXCEPTIONAL EVENTS

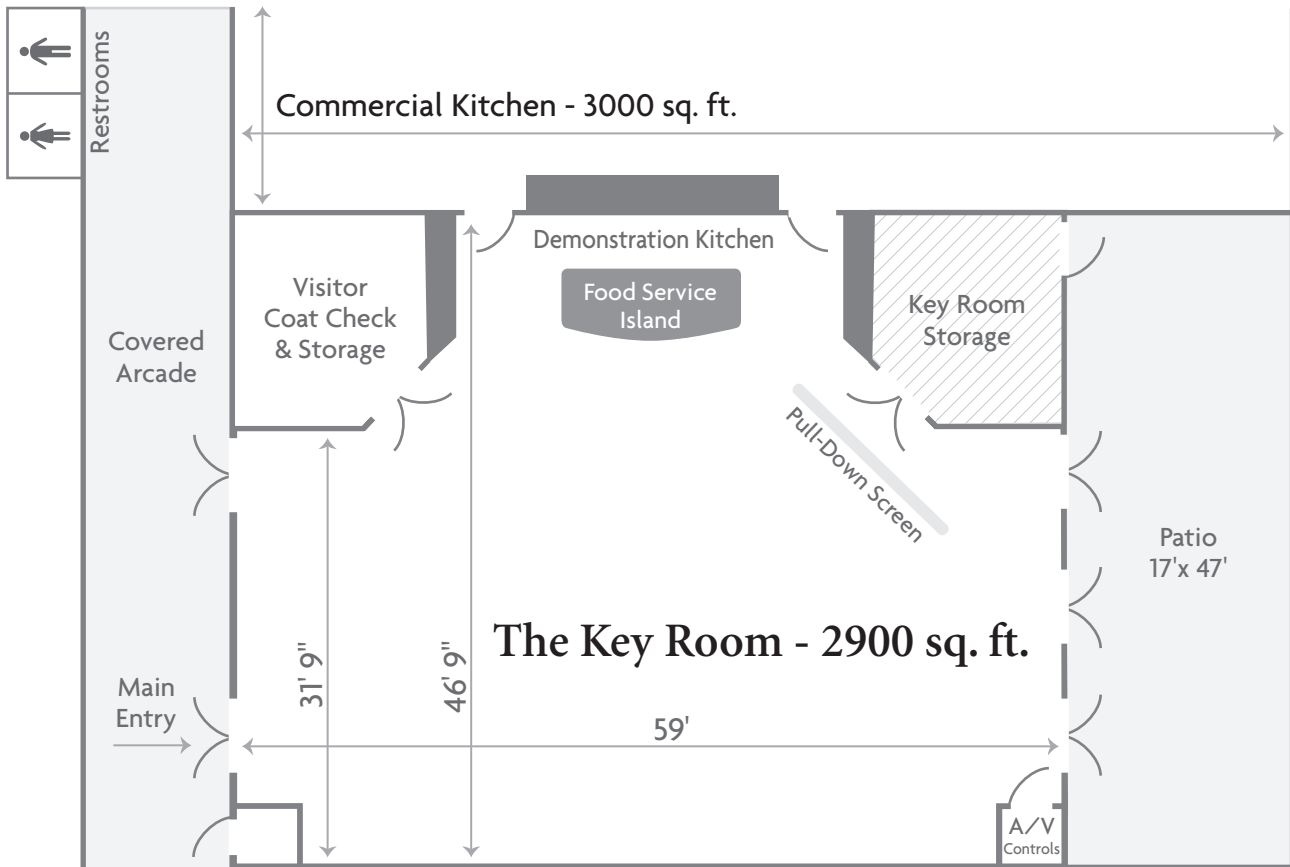

THE KEY ROOM: FLOORPLAN

**THE KEY ROOM**

- Standing and Seating Capacity:
  - Theater Seating - 150 people
  - Dining Seating - 120 people
  - Standing - 300 people
- Ample free parking for all of your guests.
- Full audiovisual system with a drop-down screen.
- 20 miles north of the Golden Gate Bridge.

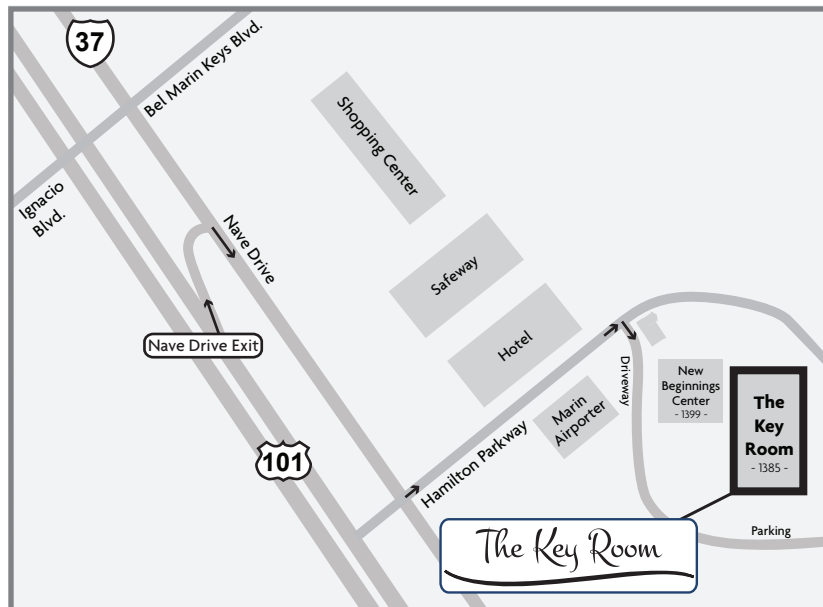

THE KEY ROOM: DIRECTIONS